

# DEARBORN *Harrow*s

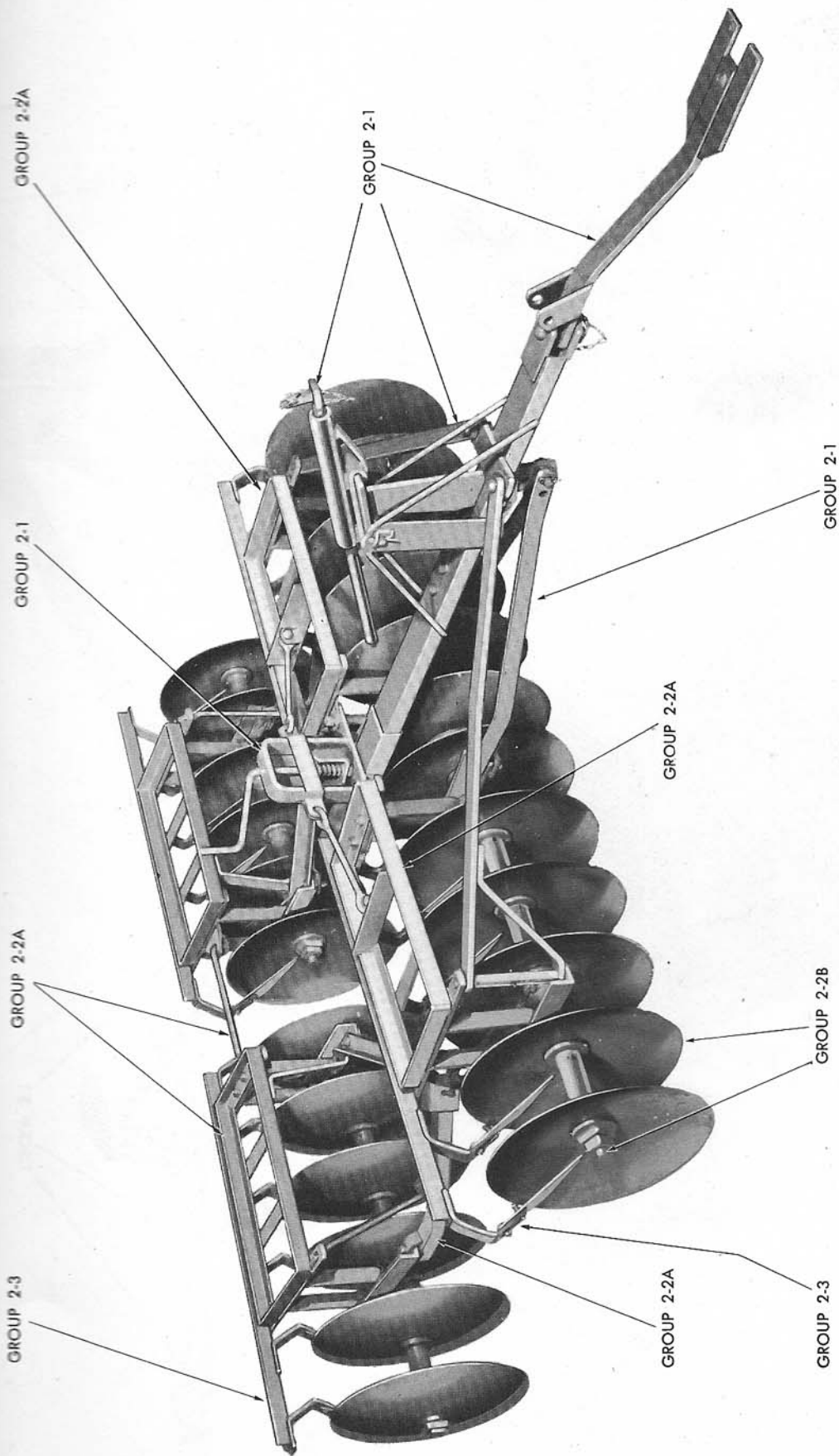

Figure 2 - Dearborn Tandem Disc Harrow, Series 'B'

# DEARBORN TANDEM DISC Harrows

SERIES "B" MODELS 11-5, 11-6, 11-7, AND 11-8

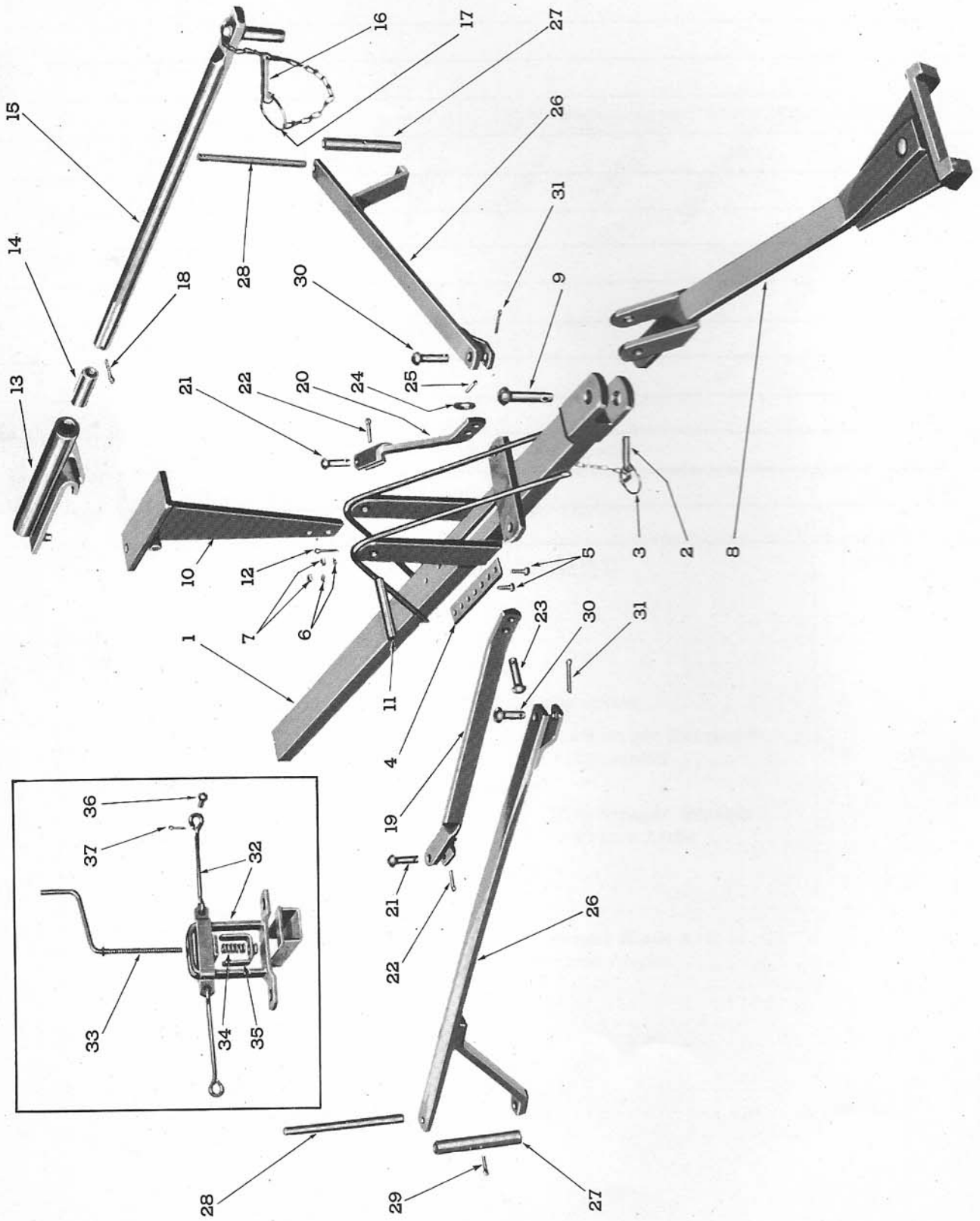

Figure 10 - Hitch and Lever Angling Assemblies

# DEARBORN TANDEM DISC *Harrow*s

SERIES "B" MODELS 11-5, 11-6, 11-7, AND 11-8

## Group 2—DEARBORN TANDEM DISC HARROWS Series "B"—Models 11-5, 11-6, 11-7, and 11-8

FIG. 10	PART NO.	NAME AND DESCRIPTION	QTY. REQ.
<b>Group 2-1—HITCH AND LEVER ANGLING ASSEMBLIES</b>			
1	110264	TONGUE, Hitch, (Welded Assembly) . . . . .	1
2	2N-574	PIN, Linch	
3	2N-575	RING, Linch Pin Locking } Hitch Tongue to Tractor Hitch . . . . .	1
4	110089	STOP, Angling Lever . . . . .	1
5	20389-S7-8	BOLT, 3/8" - 24 x 1" Hex. Hd. } Angling Lever Stop to Hitch Tongue . . . . .	2
6	34807-S7-8	LOCKWASHER, 3/8"	
7	33800-S7-8	NUT, 3/8" - 24 Hex.	
8	110247	HITCH, Tractor (Welded Assembly) . . . . .	1
9	300096	PIN, 3/8" x 3-1/4" - Hitch to Hitch Tongue . . . . .	1
10	110270	LEVER, Angling (Welded Assembly) . . . . .	1
11	110094	PIN, 5/8" x 4-1/2" Button Hd. } Angling Lever to Hitch Tongue Pivot . . . . .	2
12	72037-S7-8	COTTER PIN, 3/16" x 1"	
13	110272	PLATE and TUBE ASSEMBLY, Booster . . . . . Consists of Plate and Tube which are not serviced separately plus Bearing listed below:	1
14	110099	BEARING, Oilite . . . . .	2
15	110101	BAR and CHAIN, Control (Welded Assembly) . . . . .	1
16	2N-574	PIN, Linch	
17	2N-575	RING, Linch Pin Locking } Control Bar to Tractor Drawbar . . . . .	1
18	72073-S7-8	COTTER PIN, 3/16" x 1-1/2" - Control Bar Stop . . . . .	1
19	110257	DRAFT BAR, RH, Inside (Welded Assembly) . . . . .	1
20	110258	DRAFT BAR, LH, Inside (Welded Assembly) . . . . .	1
21	300094	PIN, 5/8" x 2-1/4" Rd. Hd. Drilled } Inside Draft Bar to Support Angle . . . . .	2
22	72075-S7-8	COTTER PIN, 1/4" x 1-1/2"	
23	300098	PIN, 5/8" x 2-3/8" Rd. Hd. Drilled } Inside Draft Bar to Angling Lever . . . . .	1
24	34721-S7-8	WASHER, 5/8" Flat	
25	72075-S7-8	COTTER PIN, 1/4" x 1-1/2"	
26	110261	DRAFT BAR, Outside (Welded Assembly) . . . . .	2
27	111624	SPACER	
28	111622	PIN, 5/8" x 9-1/2" } Outside Draft Bar to Support Angle . . . . .	2
29	72073-S7-8	COTTER PIN, 3/16" x 1-1/2"	
30	300094	PIN, 5/8" x 2-1/4" Rd. Hd. Drilled } Outside Draft Bar to Hitch Tongue . . . . .	2
31	72075-S7-8	COTTER PIN, 1/4" x 1-1/2"	
32	110121	FRAME, Front Gang Leveling (Welded Assembly) . . . . .	1
33	110229	CRANK, Adjusting . . . . .	1
34	110131	SPRING, Leveling . . . . .	1
35	110132	LIFTER, Rider (Welded Assembly) . . . . .	1
36	300314	PIN, 5/8" x 1-3/4"	
37	72075-S7-8	COTTER PIN, 1/4" x 1-1/2" } Leveling Frame to Weight Box . . . . .	2

# DEARBORN TANDEM DISC Harrows

SERIES "B" MODELS 11-5, 11-6, 11-7, AND 11-8

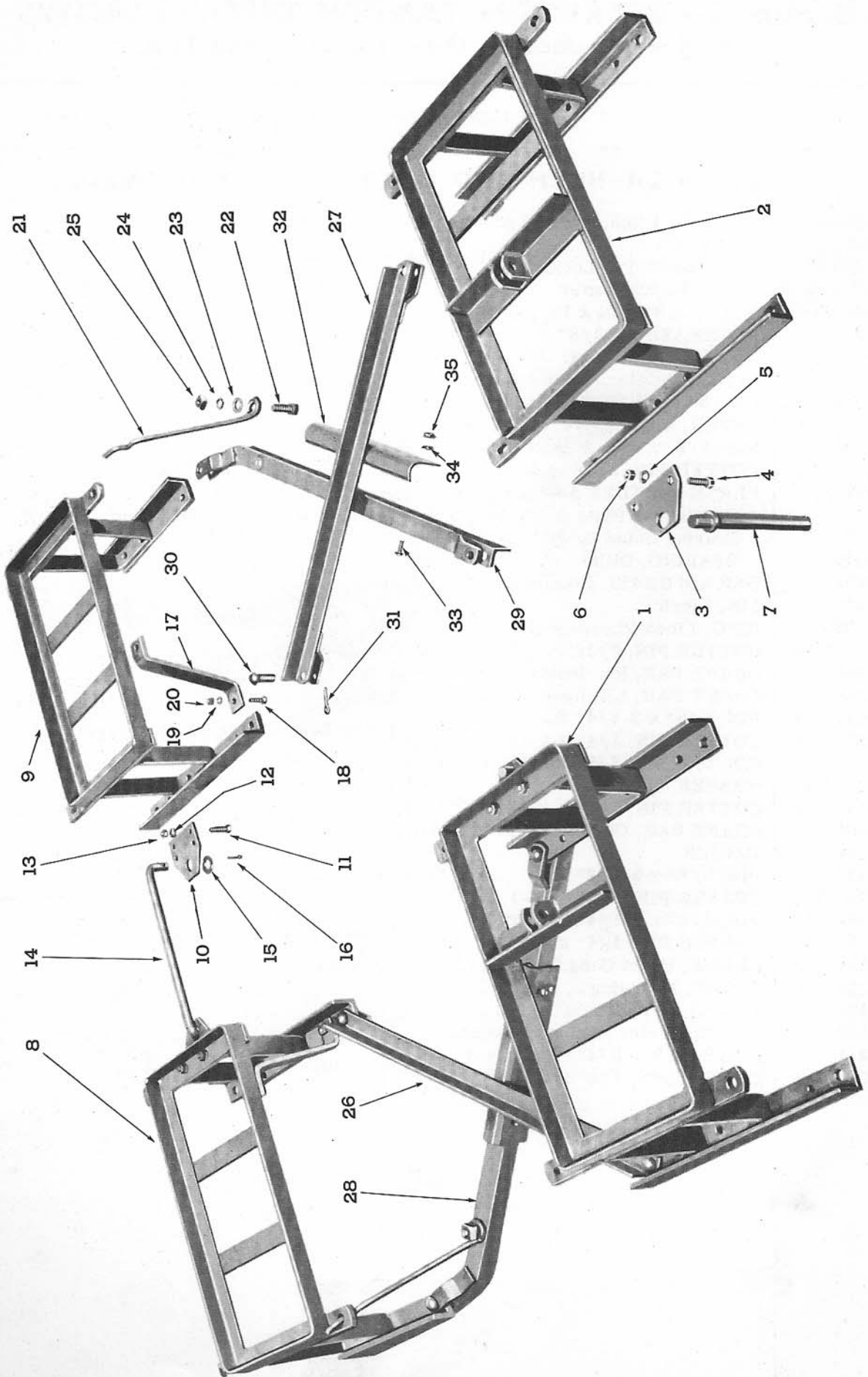

Figure 11 - Gang Frame Assemblies

**Group 2-2 GANG ASSEMBLIES**

FIG. 11	PART NO.	NAME AND DESCRIPTION	QTY. REQ.
<b>Group 2-2A-GANG FRAME ASSEMBLIES</b>			
1	110142	FRAME, Front Right (Welded Assembly) . . . . .	1
2	110143	FRAME, Front Left (Welded Assembly) . . . . .	1
3	110154	PLATE, Spindle . . . . .	2
4	20471-S7-8	BOLT, 7/16" - 20 x 1-1/2" Hex. Hd. } Spindle Plate to Frame . . . . .	4
5	34808-S7-8	LOCKWASHER, 7/16" }	
6	33802-S7-8	NUT, 7/16" - 20 Hex. }	
7	110223	SPINDLE, Front Gang . . . . .	2
8	110182	FRAME, Rear Right (Welded Assembly) . . . . .	1
9	110183	FRAME, Rear Left (Welded Assembly) . . . . .	1
10	110184	PLATE, Swivel . . . . .	2
11	20471-S7-8	BOLT, 7/16" - 20 x 1-1/2" Hex. Hd. } Swivel Plate to Frame . . . . .	4
12	34808-S7-8	LOCKWASHER, 7/16" }	
13	33802-S7-8	NUT, 7/16" - 20 Hex. }	
14	110226	ROD, Rear Gang Tie . . . . .	1
15	34723-S7-8	WASHER, 3/4" Flat } Tie Rod to Swivel Plate . . . . .	2
16	72075-S7-8	COTTER PIN, 1/4" x 1-1/2" }	
17	110187	BRACE, Frame . . . . .	2
18	20131-S7-8	BOLT, 7/16" - 20 x 1-1/4" Hex. Hd. } Frame Brace to Frame . . . . .	4
19	34808-S7-8	LOCKWASHER, 7/16" }	
20	33802-S7-8	NUT, 7/16" - 20 Hex. }	
21	110227	ROD, Support . . . . .	2
22	21047-S7-8	BOLT, 5/8" - 18 x 1-3/4" Hex. Hd. } Support Rod to Lower Drawbar . . . . .	2
23	34721-S7-8	WASHER, 5/8" Plain }	
24	34811-S7-8	LOCKWASHER, 5/8" }	
25	33850-S7-8	NUT, 5/8" - 18 Hex. }	
26	110254	DRAWBAR, Cross, Upper Right (Welded Assembly) . . . . .	1
27	110253	DRAWBAR, Cross, Upper Left (Welded Assembly) . . . . .	1
28	110255	DRAWBAR, Cross, Lower Right (Welded Assembly) . . . . .	1
29	110256	DRAWBAR, Cross, Lower Left (Welded Assembly) . . . . .	1
30	300314	PIN, 5/8" x 1-3/4" Rd. Hd. Drilled } Drawbar to Front and Rear Frames . . . . .	8
31	72075-S7-8	COTTER PIN, 1/4" x 1-1/2" }	
32	110211	PLATE, Leveling . . . . .	2
33	20389-S7-8	BOLT, 3/8" - 24 x 1" Hex. Hd. } Leveling Plate to Drawbar . . . . .	4
34	34807-S7-8	LOCKWASHER, 3/8" }	
35	33800-S7-8	NUT, 3/8" - 24 Hex. }	

# DEARBORN TANDEM DISC Harrows

SERIES "B" MODELS 11-5, 11-6, 11-7, AND 11-8

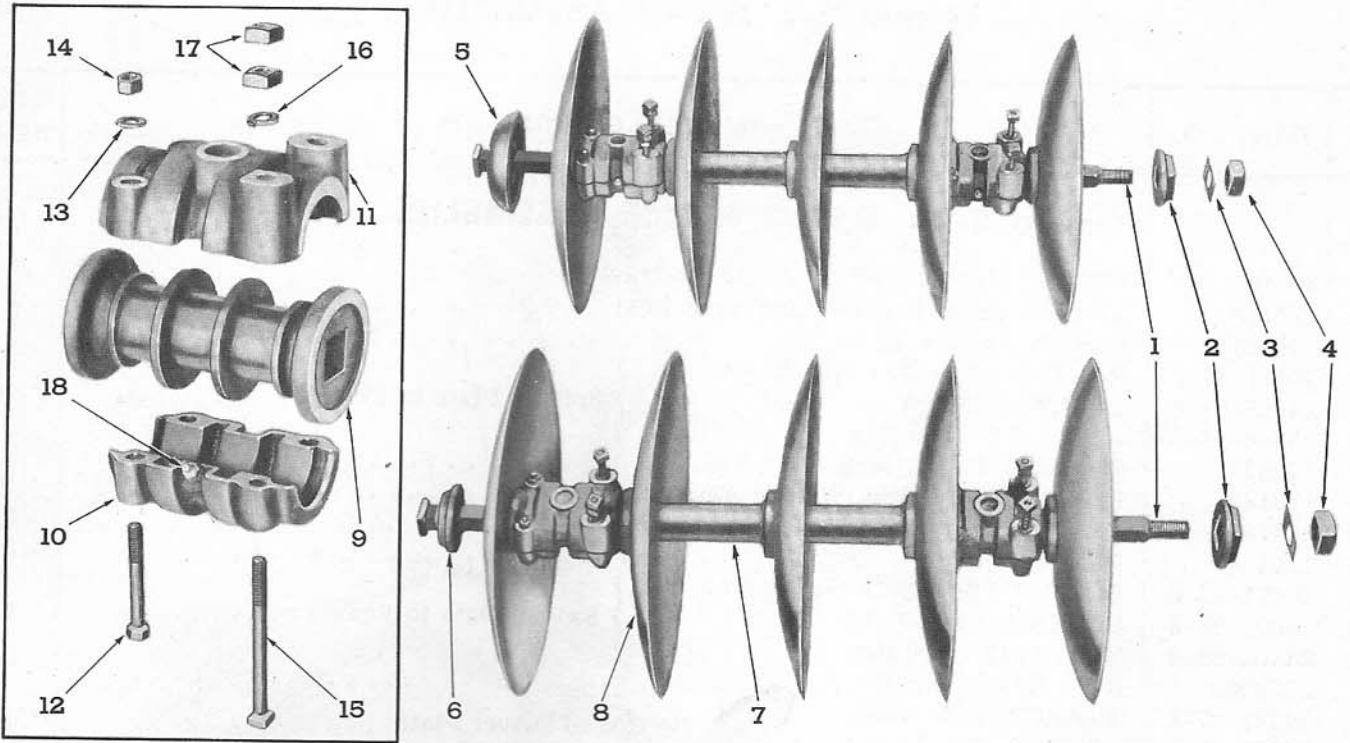

Figure 12 - Disc and Bearing Assemblies

FIG. 12	PART NO.	NAME AND DESCRIPTION	QTY. REQ.			
			11-5	11-6	11-7	11-8
<b>Group 2-2B—DISC AND BEARING ASSEMBLIES</b>						
-	110157	BOLT, Gang, 6'	4		4	
1	110158	BOLT, Gang, 7'				4
2	110168	WASHER		4		
3	110169	LOCK				
4	300041	NUT, 1" - 8 Sq. } Gang Bolt	4	4	4	4
5	110159	BUMPER, Front Gang	2	2	2	2
6	110168	WASHER, Gang Bolt (Head End)	2	2	2	2
7	110163	SPOOL, Spacer	8	12	8	12
-	110164	DISC, 16" Dia.	20			
8	110166	DISC, 18" Dia.		24		
9	110160	SPOOL, Bearing			20	24
10	110161	CAP, Lower Bearing	8	8	8	8
11	110162	CAP, Upper Bearing	8	8	8	8
12	21568-S7-8	BOLT, 7/16" - 20 x 3-1/4" Hex. Hd. } Upper to Lower				
13	34808-S7-8	LOCKWASHER, 7/16" } Bearing Cap				
14	33802-S7-8	NUT, 7/16" - 20 Hex. }	16	16	16	16
15	21624-S7-8	BOLT, 7/16" - 20 x 5" Hex. Hd. } Upper to Lower	16	16	16	16
16	34808-S7-8	LOCKWASHER, 7/16" } Bearing Cap	16	16	16	16
17	33802-S7-8	NUT, 7/16" - 20 Hex. } to Frame	32	32	32	32
18	353027-S7-8	FITTING, Lube - Lower Bearing Cap	8	8	8	8

# DEARBORN TANDEM DISC Harrows

SERIES "B" MODELS 11-5, 11-6, 11-7, AND 11-8

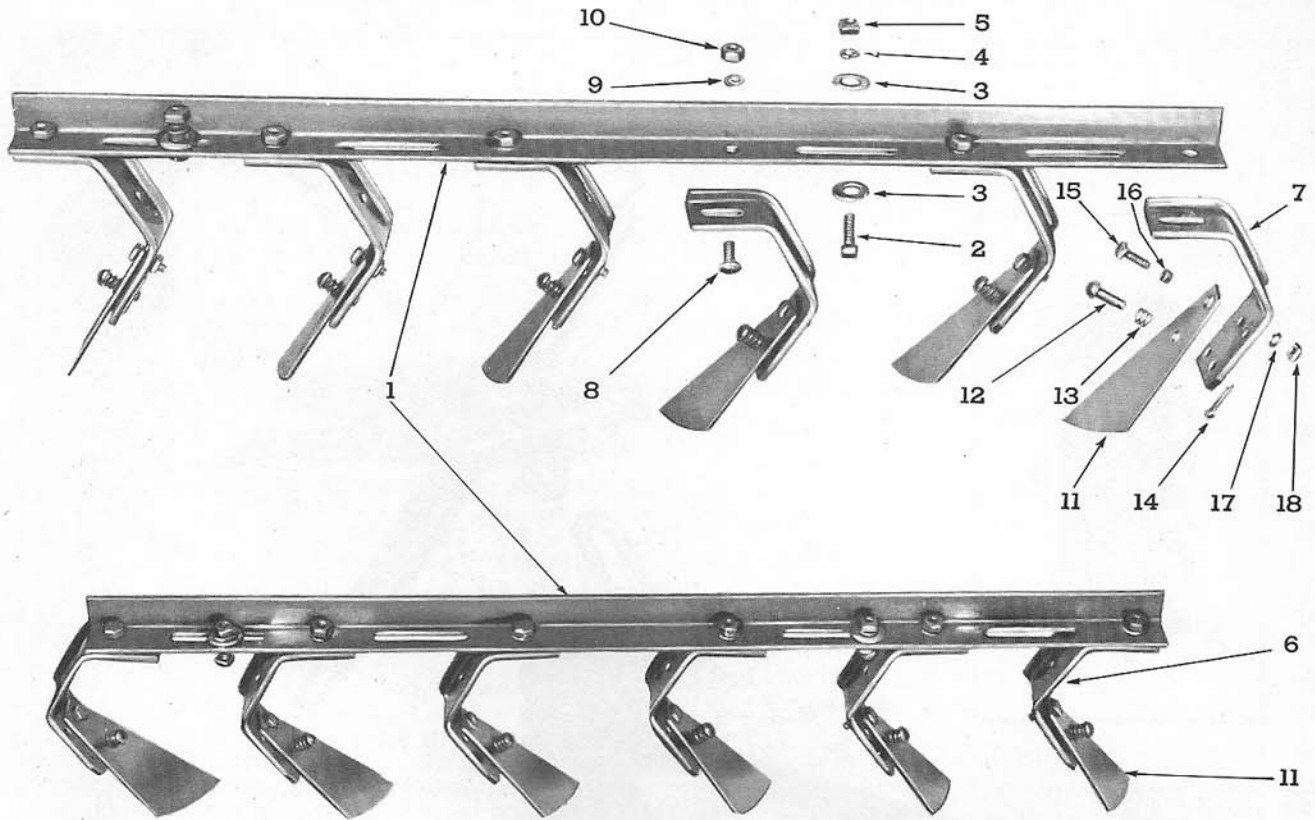

Figure 13 - Scraper Assemblies

FIG. 13	PART NO.	NAME AND DESCRIPTION	QTY. REQ.			
			11-5	11-6	11-7	11-8
<b>Group 2-3—SCRAPER ASSEMBLIES</b>						
-	110152	RAIL, Scraper, 6' . . . . .	4		4	
1	111623	RAIL, Scraper, 7' . . . . .				4
2	20429-S7-8	BOLT, 3/8" - 24 x 1-1/4" Hex. Hd. . . . .	8	8	8	8
3	34747-S7-8	WASHER, 3/8" Plain . . . . .	16	16	16	16
4	34807-S7-8	LOCKWASHER, 3/8" . . . . .	8	8	8	8
5	33800-S7-8	NUT, 3/8" - 24 Hex. . . . .	8	8	8	8
6	110192	BRACKET, Scraper, Right Front and Left Rear . . . . .	10	12	10	12
7	110193	BRACKET, Scraper, Left Front and Right Rear . . . . .	10	12	10	12
8	23412-S7-8	BOLT, 7/16" - 14 x 1" Carr. . . . .				
9	34808-S7-8	LOCKWASHER, 7/16" . . . . .				
10	33801-S7-8	NUT, 7/16" - 14 Hex. . . . .	20	24	20	24
11	110194	BLADE, Scraper . . . . .	20	24	20	24
12	300095	PIN, 3/8" x 1-1/4" Rd. Hd. Drilled . . . . .				
13	110196	SPRING . . . . .				
14	72037-S7-8	COTTER PIN, 3/16" x 1" . . . . .	20	24	20	24
15	300097	BOLT, 5/16" - 24 x 1" Sq. Hd. . . . .				
16	110197	SPACER . . . . .				
17	34806-S7-8	LOCKWASHER, 5/16" . . . . .	20	24	20	24
18	33798-S7-8	NUT, 5/16" - 24 Hex. . . . .				